

DESIGN FEATURES

- **Simple And Compact**
Simple design and compact working length allows for installation in a wide variety of pumps, both internally and externally.
- **Chemical Compatibility**
The wide choice of O-Ring and face material combinations provides excellent compatibility in almost any chemical application.
- **Reliable Positive Drive**
Grub Screws provide bi-directional positive drive from the shaft through to the seal face, eliminating slippage and increasing reliability.

APPLICATIONS

- Capable of handling a wide range of chemicals & abrasive media.
- Suitable for almost all Sectors of Industry: e.g. Waste Water Industry, Food & Beverage Industry and Chemical Industry.
- Water Pumps, Lobe Pumps, Gear Pumps & Chemical Pumps.

OPERATING CONDITIONS

- **Pressure**
≤ 10 Bar. (145 psi)
- **Temperature**
- 30°C ~ 204°C
- **Shaft Speed**
≤ 15m/sec

MATERIAL OPTIONS

- **Retainer/Spring**
304 SS / 316 SS
- **Rotary Face**
Carbon, 316 SS, Silicon Carbide & Tungsten Carbide
- **Stationary Face**
Carbon, 316 SS, Silicon Carbide & Tungsten Carbide
- **Elastomers**
Nitrile, Viton, Neoprene & EPR

SIZE RANGE

- **Imperial Shaft Size**
0.625" ~ 4.000"
- **Metric Shaft Size**
16mm ~ 100mm



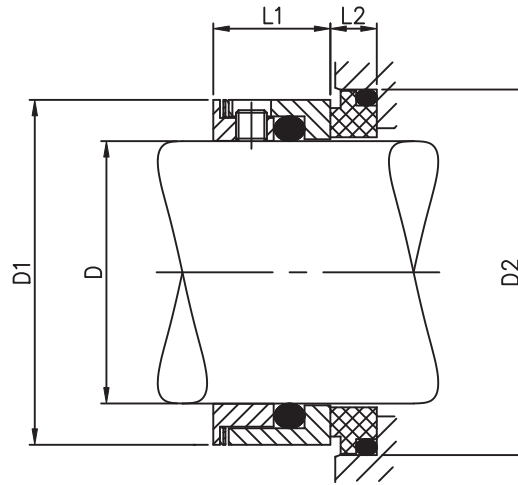

T80 Dimensions

Imperial

Metric

SHAFT SIZE	D	D1	D2	L1	L2
0.625" (5/8")	15.88	26.6	28.60	18.4	7.0
0.750" (3/4")	19.05	29.7	31.75	18.4	7.0
0.875" (7/8")	22.23	34.5	34.95	18.4	7.0
1.000" (1")	25.40	37.0	38.10	19.0	8.0
1.125" (1 1/8")	28.58	40.0	41.30	19.0	8.0
1.250" (1 1/4")	31.75	43.7	44.45	19.0	8.0
1.375" (1 3/8")	34.93	46.5	47.65	19.0	8.0
1.500" (1 1/2")	38.10	49.8	50.80	19.0	8.0
1.625" (1 5/8")	41.28	56.0	57.15	21.5	8.5
1.750" (1 3/4")	44.45	58.5	60.30	21.5	8.5
1.875" (1 7/8")	47.63	62.0	63.50	21.5	8.5
2.000" (2")	50.80	65.1	66.65	22.7	9.0
2.125" (2 1/8")	53.98	68.0	73.00	22.7	9.0
2.250" (2 1/4")	57.15	74.0	76.20	22.7	9.0
2.375" (2 3/8")	60.33	77.2	79.40	22.7	9.0
2.500" (2 1/2")	63.50	80.4	82.55	22.7	9.0
2.750" (2 3/4")	69.85	86.7	88.90	22.7	9.0
2.875" (2 7/8")	73.03	91.4	92.10	22.7	9.0
3.000" (3")	76.20	92.0	95.25	25.5	9.5
3.250" (3 1/4")	82.55	99.2	101.60	25.5	9.5
3.500" (3 1/2")	88.90	106.5	107.95	28.0	10.0
3.750" (3 3/4")	95.25	112.8	114.30	28.0	10.0
4.000" (4")	101.60	122.0	127.00	28.0	10.0

SHAFT SIZE	D	D1	D2	L1	L2
16mm	16.00	26.6	28.60	18.4	7.0
18mm	18.00	28.6	31.00	18.4	7.0
20mm	20.00	30.6	33.00	18.4	7.0
22mm	22.00	32.9	35.00	18.4	7.0
25mm	25.00	37.0	38.00	19.0	8.0
28mm	28.00	40.0	42.00	19.0	8.0
30mm	30.00	42.0	44.00	19.0	8.0
32mm	32.00	43.5	45.00	19.0	8.0
35mm	35.00	46.5	47.60	19.0	8.0
38mm	38.00	49.8	52.00	19.0	8.0
40mm	40.00	53.0	54.00	21.5	8.5
45mm	45.00	58.8	60.00	21.5	8.5
48mm	48.00	61.0	63.00	21.5	8.5
50mm	50.00	63.0	64.00	22.7	9.0
55mm	55.00	71.0	75.00	22.7	9.0
60mm	60.00	76.0	80.00	22.7	9.0
63mm	63.00	79.0	83.00	22.7	9.0
65mm	65.00	81.0	85.00	22.7	9.0
70mm	70.00	86.0	90.00	22.7	9.0
75mm	75.00	90.0	100.00	25.5	9.5
80mm	80.00	96.0	105.00	25.5	9.5
85mm	85.00	105.0	110.00	28.0	10.0
90mm	90.00	109.6	115.00	28.0	10.0
95mm	95.00	115.0	125.00	28.0	10.0
100mm	100.00	120.0	130.00	28.0	10.0